

Eminence District Towersites

Doniphan Towersite
Rose Hill Towersite
Thomasville Towersite
Hunter Towersite

Twenty Year Area Management Plan FY 2015-2034



Lisa M. Allen

Forestry Division Chief

Date

Eminence District Towersites Management Plan Approval Page

PLANNING TEAM

Steve Paes, Resource Forester

George Kipp, Resource Forester

Susan Farrington, Natural History Biologist

Darren Killian, Conservation Agent

Paul Veatch, Conservation Agent

Brad Hadley, Conservation Agent

David Baldrige, Conservation Agent

Don Foerster, Private Land Conservationist

Melanie Carden-Jessen, Education Center Manager

OZARK REGION

RCT Chair

Signature

Date

FORESTRY DIVISION

Unit Chief

Signature

Date

OVERVIEW

Area Name	Area Number	Year Acquired	Acreage	County	Administrative Responsibility	Maintenance Responsibility
Doniphan Towersite	6323	1963	9.6	Ripley	Forestry	Forestry
Rose Hill Towersite	6006	1960	8	Oregon	Forestry	Forestry
Thomasville Towersite	4907	1949	40	Shannon	Forestry	Forestry
Hunter Towersite	4703	1947	75	Carter	Forestry	Forestry

Statements of Purpose:

A. Strategic Direction

These areas were obtained primarily for the purpose of detecting wildfires. Fire detection, however, is no longer the principal purposes of these areas. The Rose Hill Tower is likely eligible for listing on the National Register of Historic Places and, therefore, has historical and cultural value.

- Doniphan Towersite is still used regularly for fire detection. Its primary uses have become the work center for the Ripley/Oregon County work team, equipment storage for Protection Division, and as a repeater site.
- Rose Hill Tower Site is no longer used for fire detection. Its primary purpose is now as a radio repeater site.
- Thomasville Tower Site is used for fire detection sporadically. The primary purpose has become the management of the forest resource.
- Hunter Tower Site is still used primarily for fire detection. Other uses are forest management, a radio repeater site and an emergency siren.

B. Desired Future Condition

Maintain structural integrity of the towers and other facilities to ensure safety of Missouri Department of Conservation (the Department) personnel and the public. Manage surrounding forests to ensure healthy, sustainable, forest resources and to protect groundwater and surface water quality.

C. Federal Aid Statement

N/A

GENERAL INFORMATION AND CONDITIONS

I. Special Considerations

Area	Priority Area	Natural Area
Doniphan Towersite	Priority Forest Landscape	None
Rose Hill Towersite	None	None
Thomasville Towersite	Priority Forest Landscape, Little Black River Fisheries Priority Watershed	None
Hunter Towersite	Priority Forest Landscape	None

II. Important Natural Features and Resources

Area	Species of Conservation Concern	Caves	Springs
Doniphan Towersite	None	None	None
Rose Hill Towersite	None	None	None
Thomasville Towersite	None	None	None
Hunter Towersite	None	None	None

III. Existing Infrastructure

Area	Privy	Parking Lots	Other
Doniphan Towersite	1	1	100' fire tower, radio repeater, private cell tower, shop
Rose Hill Towersite	0	0	100' fire tower, radio repeater, locked gate.
Thomasville Towersite	0	0	100' fire tower, locked gate
Hunter Towersite	0	1	80' fire tower, radio repeater, emergency siren, locked gate

IV. Area Restrictions or Limitations

Area	Deed Restrictions	Federal Interest	Cultural Resources	Hazards	Endangered Species	Boundary Issues	Other
Doniphan Towersite	None	Yes ¹	None known	None	None	None	No hunting
Rose Hill Towersite	None	Yes ¹	Yes ²	None	None	None	
Thomasville Towersite	None	Yes ¹	None known	None	None	None	
Hunter Towersite	None	Yes ¹	None known	None	None	Possible ³	

¹ Federal funds may be used in the management of this land. Fish and wildlife agencies may not allow recreational activities and related facilities that would interfere with the purpose for which

the State is managing the land. Other uses may be acceptable and must be assessed in each specific situation.

² The Rose Hill Towersite is likely eligible for listing on the National Register for Historic Sites. Records kept with the Missouri Department of Conservation (the Department) Environmental Compliance Specialist. Managers should follow Best Management Practices for Cultural Resources found in the Department Resource Policy Manual.

³ Boundaries have not been surveyed. Private inholdings may exist.

MANAGEMENT CONSIDERATIONS

V. Terrestrial Resource Management Considerations

Challenges and Opportunities:

Managing forests.

Management Objective 1: Maintain forest health.

Strategy 1: Conduct forest inventories as scheduled and implement prescribed management.

Strategy 2: Monitor for insect and diseases, and other forest health issues, whenever personnel are on-site, and treat to control or eradicate with appropriate chemical or mechanical methods.

VI. Aquatic Resource Management Considerations

Challenges and Opportunities:

Protecting groundwater and surface water quality.

Management Objective 1: Prevent erosion and protect sinkholes.

Strategy 1: Utilize appropriate Best Management Practices with any timber sale on the areas.

Strategy 2: Maintain buffers in and around sinkholes as appropriate.

VII. Public Use Management Considerations

Challenges and Opportunities:

Conducting routine maintenance.

Management Objective 1: Maintain infrastructure to Department standards.

Strategy 1: Maintain locked gates to limit public access and reduce vandalism.

APPENDICES

Maps:

- Appendix 1. Doniphan Towersite Background
- Appendix 2. Doniphan Towersite Map
- Appendix 3. Rose Hill Towersite Background
- Appendix 4. Rose Hill Towersite Map
- Appendix 5. Thomasville Towersite Background
- Appendix 6. Thomasville Towersite Map
- Appendix 7. Hunter Towersite Background
- Appendix 8. Hunter Towersite Map
- Appendix 9: Draft Eminence District Towersites Area Management Plan Public Comments

Public Input Summary:

The draft Eminence District Towersites Area Management Plan was available for a public comment period February 1–28, 2015. The Missouri Department of Conservation received comments from one respondent (Appendix 9). The Eminence District Towersites Area Planning Team carefully reviewed and considered these ideas as they finalized this document. A brief summary of public input themes, including how they were incorporated or why they were not, can be found below. Rather than respond to each individual comment, comments are grouped into general themes and are addressed collectively.

Department responses to themes and issues identified through Eminence District Towersites public comment period

Appreciates the Department maintaining fire towers and protecting them from vandalism.

The planning team, and work teams responsible for them, appreciates the recognition of efforts to maintain these sites. The maintenance will continue as established in Area Maintenance guidelines. There are no plans to dispose of any of these sites, so the historical significance will be preserved. Any future action to dispose or alter the sites will first have to go through a process, including a cultural resource review, to insure the historical significance is considered before actions are taken.

Appendix 1. Doniphan Towersite Background

The Doniphan Towersite is open to the public; the gate is locked during non-business hours.

Legal Description: Township 23 North, Range 2 East, Section 12.

Area Location: From Doniphan, go east on Highway 160 to its junction with Highway 21. Turn left (north) on Highway 21 and continue 0.5 miles to the sign. Turn left (west) on the gravel road and continue 0.25 miles to the top of the hill.

Current Land and Water Types:

Land/Water Type	Acres	% of Area
Forest	7.6	79
Open Land	2	21
Total	9.6	100

Appendix 2. Doniphan Towersite Map

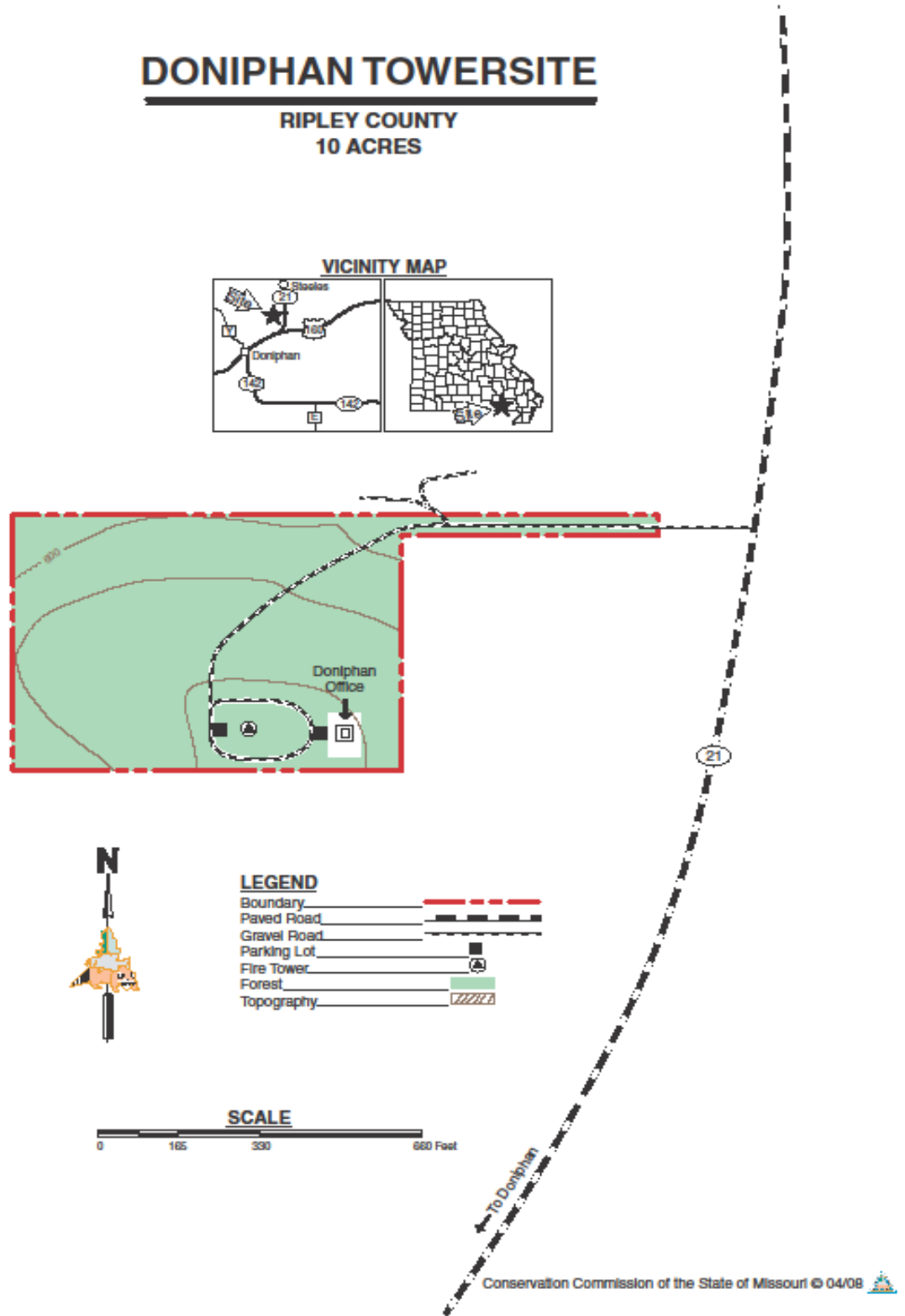

Appendix 3. Rose Hill Towersite Background

The Rose Hill Towersite is open to the public. A locked gate restricts access to the tower. The lower steps to the tower have been removed and the fire tower is not accessible to the public.

Legal Description: Township 22 North, Range 4 West, Section 20.

Area Location: Rose Hill Towersite is 7 miles east of Thayer on Highway 142. Continue 1.5 miles north on Route EE and 1 mile west on County Road 142-248.

Current Land and Water Types:

Land/Water Type	Acres	% of Area
Forest	8	100
Total	8	100

Appendix 4. Rose Hill Towersite Map

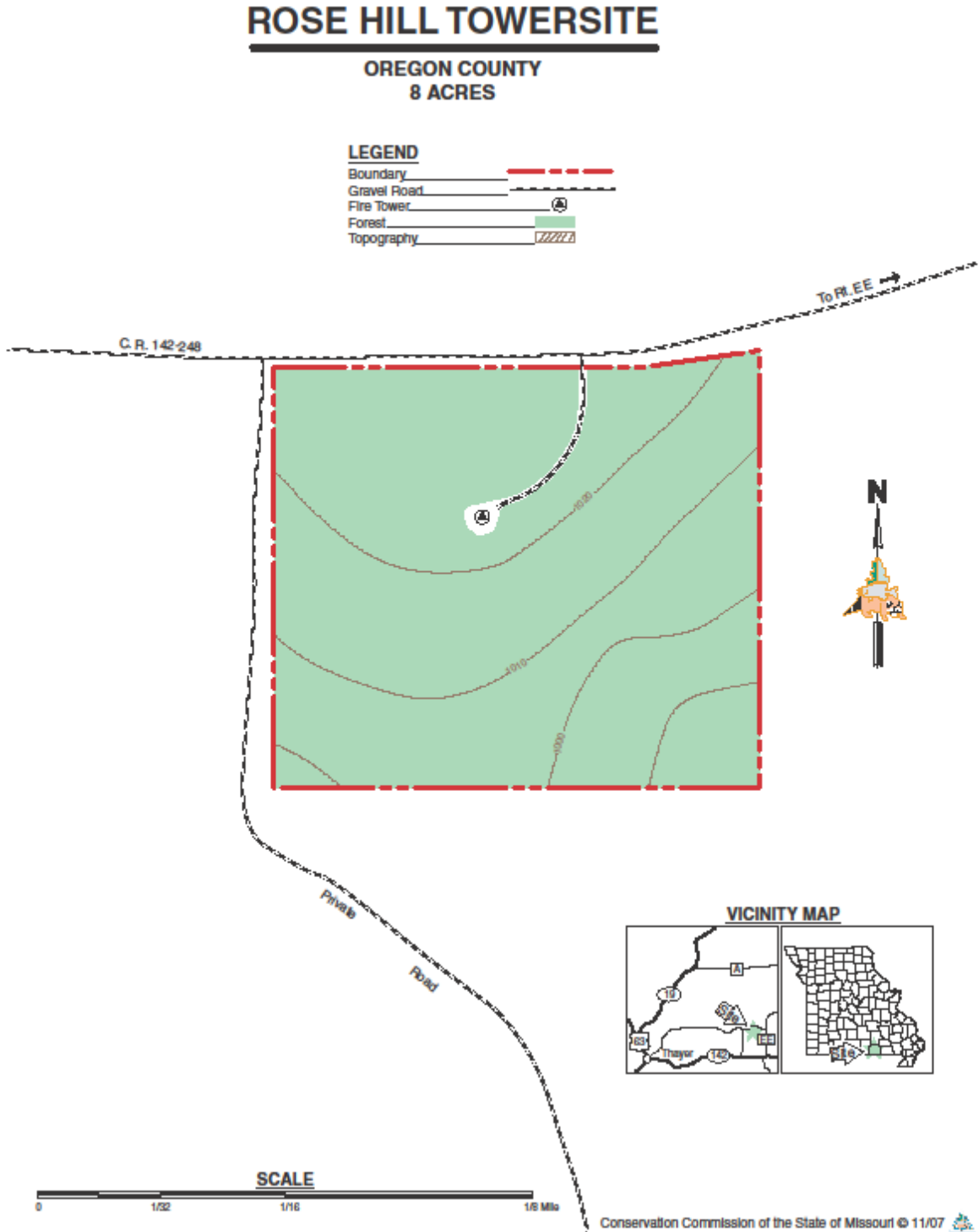

Appendix 5: Thomasville Towersite Background

The Thomasville Towersite is open to the public. There is walk-in access from the entrance gate.

Legal Description: Township 26 North, Range 6 West, Section 28.

Area Location: The Thomasville Tower Site is located south and east of Mountain View. From Highway 60, go south on Route T and travel 7 miles to Route TT. Turn west (right) on Route TT and continue approximately 1 mile to the tower site.

Current Land and Water Types:

Land/Water Type	Acres	% of Area
Forest	40	100
Total	40	100

Appendix 6. Thomasville Towersite Map

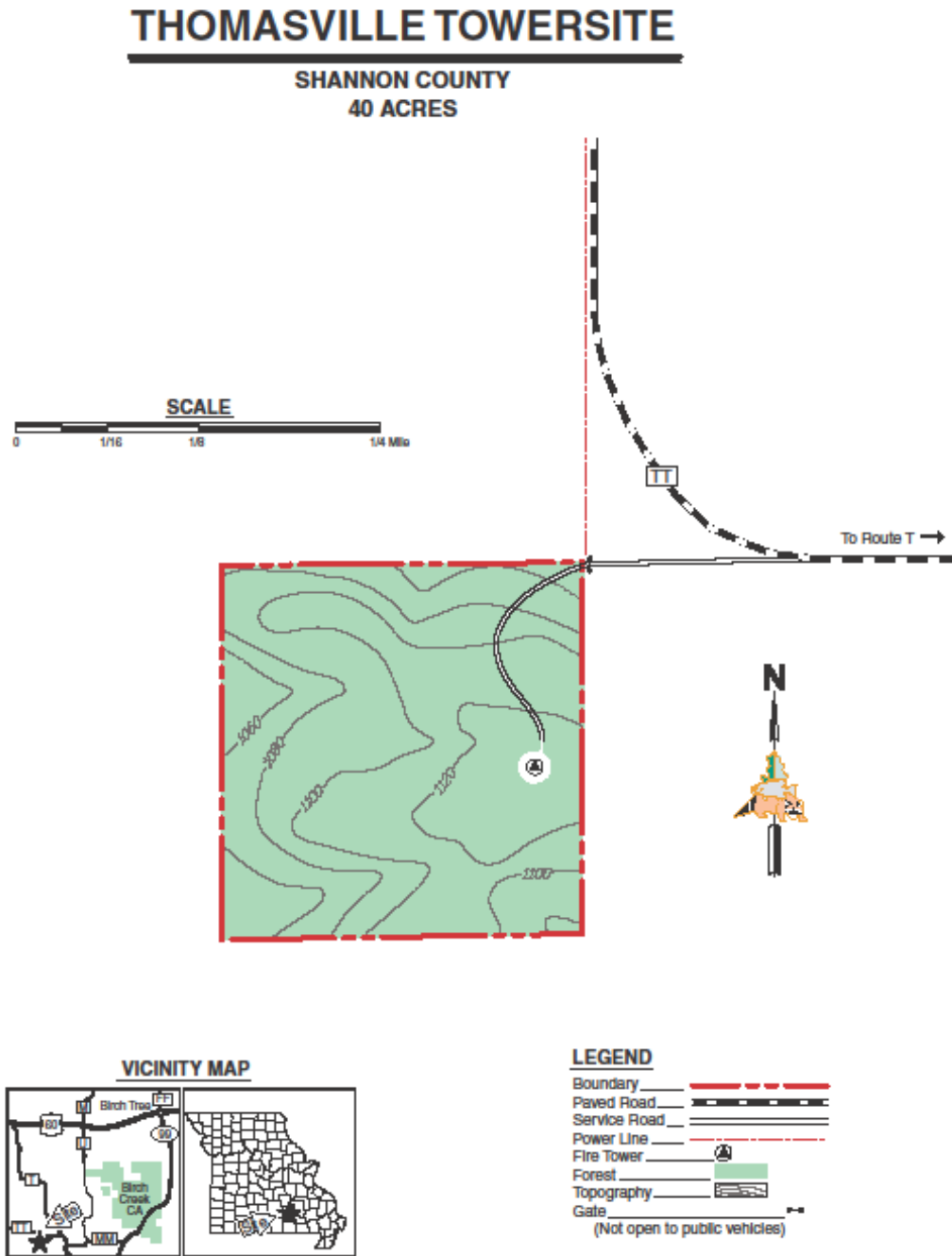

Appendix 7. Hunter Towersite Background

The Hunter Towersite is open to the public. There is walk-in access from the entrance gate.

Legal Description: Township 26 North, Range 2 East, Sections 28 & 29.

Area Location: The Hunter Tower Site is located south of Hunter, Missouri. From the town of Hunter, go south on Route E approximately 0.5 miles and turn west onto County Road O-251 to the locked gate on the right.

Current Land and Water Types:

Land/Water Type	Acres	% of Area
Forest	73	97
Open Land	2	3
Total	75	100

Appendix 8. Hunter Towersite Map

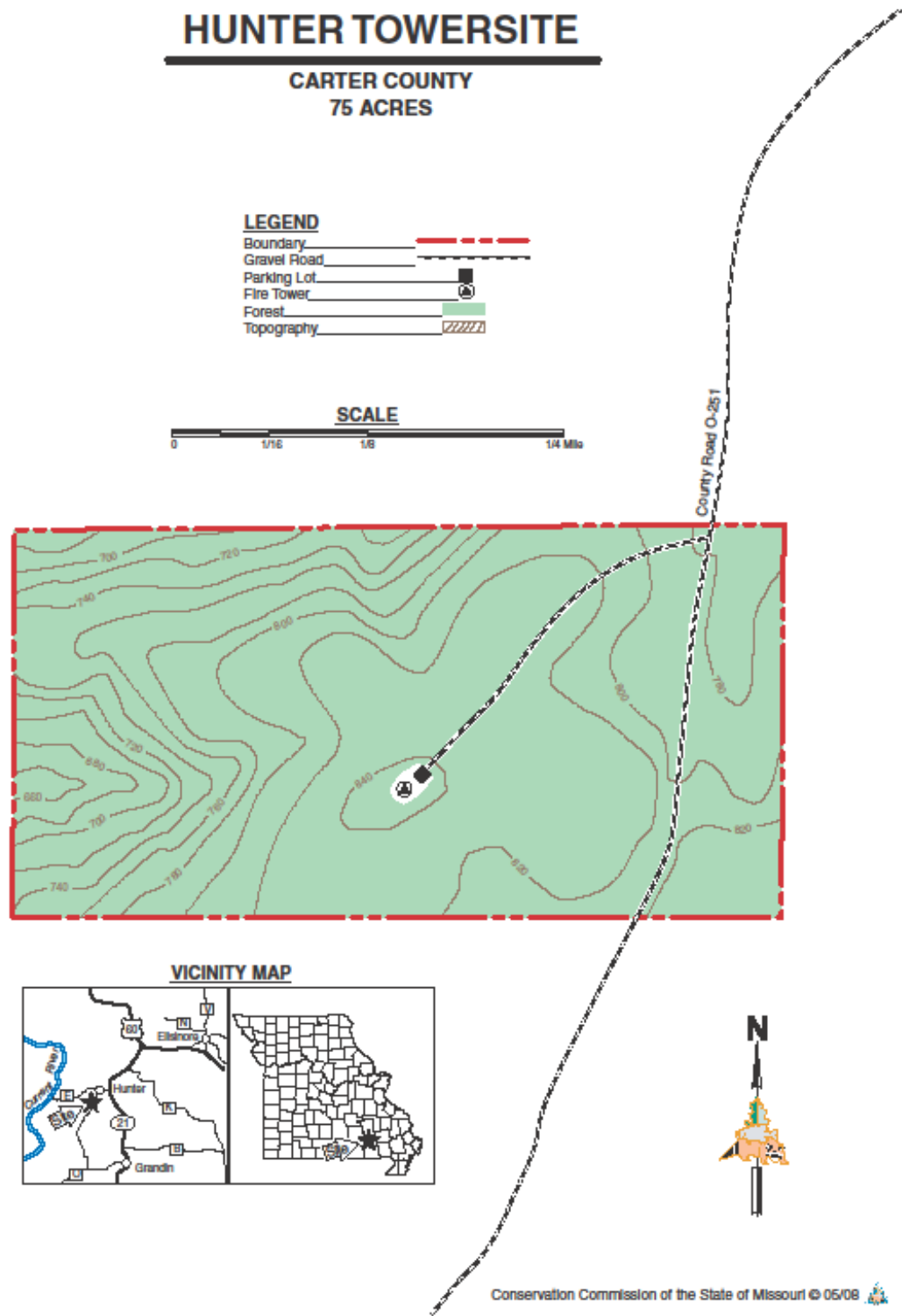

Appendix 9. Draft Eminence District Towersites Area Management Plan Public Comments

Received during public comment period (February 1-28, 2015)

Thanks so much for continuing to maintain these tower sites. These are important historical landmarks and pieces of history to teach not only about fire prevention (and its history) but also the goals of conservation here in our great state. I'm happy to see in the report that these sites are to be continued to be maintained and also steps taken to protect them from vandalism. Keep up the good work and thanks again for maintaining these important pieces of history and conservation!