

Dent County Towersites

Montauk Towersite
Lenox Towersite

Fifteen Year Area Management Plan FY 2015-2029



Lisa M. Allen
Forestry Division Chief

2-8-15
Date

Dent County Towersites Management Plan Approval Page

PLANNING TEAM

Mike Fiaoni, Resource Forester

Nick Girondo, Fisheries Management Biologist

Justin Gailey, Wildlife Management Biologist

David Ingram, Conservation Agent

Jason Midyett, Conservation Agent

Mike Gaskins, Private Land Conservationist

Carol Mahan, Conservation Education Consultant

OZARK REGION

RCT Chair

Signature

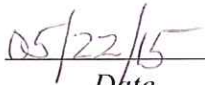
Date

FORESTRY DIVISION

Unit Chief

Signature

Date

OVERVIEW

Area Name	Area Number	Date Acquired	Acreage	County	Administrative Responsibility	Maintenance Responsibility
Montauk Towersite	5011	1950	40	Dent	Forestry	Forestry
Lenox Towersite	5620	1956	5	Dent	Forestry	Forestry

Statements of Purpose:

A. Strategic Direction

These areas were obtained and are currently maintained primarily for wildfire detection purposes. The Lenox Tower is likely eligible for listing on the National Register for Historic Places, as it was erected in 1958. The Montauk Tower, however, is not likely eligible for listing as it was built later in 1963.

B. Desired Future Condition

Maintain structural integrity of these towers to ensure safety of fire lookout personnel. Manage surrounding forests to ensure healthy, sustainable forest resources.

C. Federal Aid Statement

N/A

GENERAL INFORMATION AND CONDITIONS

I. Special Considerations

Area	Priority Area	Natural Area
Montauk Towersite	None	None
Lenox Towersite	None	None

II. Important Natural Features and Resources

Area	Species of Conservation Concern	Caves	Springs
Montauk Towersite	None	None	None
Lenox Towersite	None	None	None

III. Existing Infrastructure

Area	Parking Areas	Other
Montauk Towersite	1	1 fire tower
Lenox Towersite	1	1 fire tower

IV. Area Restrictions or Limitations

Area	Deed Restrictions	Federal Interest	Cultural Resources	Hazards	Endangered Species	Boundary Issues
Montauk Towersite	None	None	None	None	None	None
Lenox Towersite	None	None	Yes ¹	None	None	None

¹ Records are kept with Missouri Department of Conservation (the Department) Environmental Compliance Specialist. Managers should follow Best Management Practices for Cultural Resources found in the Department Resource Policy Manual.

MANAGEMENT CONSIDERATIONS

I. Terrestrial Resource Management Considerations

Challenges and Opportunities:

Managing forests around the towers.

Management Objective 1: Manage forests.

Strategy 1: Assess forests through forest inventory for health and potential improvement. (Forestry)

II. Public Use Management Considerations

Challenges and Opportunities:

- 1) Recurring vandalism to the towers.
- 2) Conducting routine maintenance.

Management Objective 1: Reduce/eliminate vandalism.

Strategy 1: Maintain a high level of law enforcement presence. (Forestry and Protection)

Strategy 2: Continue routine maintenance on both sites according to policy and need. (Forestry)

III. Administrative Considerations

Challenges and Opportunities:

Ensuring safety of fire lookout personnel.

Management Objective 1: Ensure structural integrity of the towers.

Strategy 1: Insist that an annual inspection of the structural integrity of each tower is completed and reported by a qualified entity. (Forestry)

Strategy 2: Personnel will visually inspect condition of the towers on a regular basis. (Forestry)

MANAGEMENT TIMETABLE

All strategies are considered ongoing.

APPENDICES

Maps:

Appendix 1. Montauk Towersite Background

Appendix 2. Montauk Towersite Map

Appendix 3. Lenox Towersite Background

Appendix 4. Lenox Towersite Map

Appendix 5. Dent County Towersites Management Plan Public Comments

Public Input Summary:

The draft Dent County Towersites Area Management Plan was available for a public comment period January 1–31, 2015. The Missouri Department of Conservation received comments from three respondents (Appendix A). The Dent County Towersites Planning Team carefully reviewed and considered these ideas as they finalized this document. A brief summary of public input themes, including how they were incorporated or why they were not, can be found below. Rather than respond to each individual comment, comments are grouped into general themes and are addressed collectively.

Department responses to themes and issues identified through Dent County Towersites public comment period

Appreciates the historic prospective and outdoor opportunity for adventure that the towersite provides.

The planning team agrees that the towers are part of the area's history with fire and are still used in heavy fire years. The towers themselves are available for the general public to climb at their own risk, but the cab at the top is not open for public use.

Interested in purchasing this towersite, if available.

The Department periodically reviews properties to assess whether to dispose of areas. This determination is based on a thorough evaluation of the need for the property, cost-effectiveness, and consequences of retention or disposal on resource management. Historic importance and public reaction to disposal are also considerations, as well as aesthetic considerations and liability. At this time the Department has no plans to dispose of the towers or the properties. However, if in the future the decision is made to sell the towers and/or properties, notices would be sent out and they would be put up for public auction.

Concerned about unlawful or rowdy behavior at the towersite and the safety of those that climb the tower.

The planning team shares the concern about unlawful and rowdy behavior at the towersites and the safety of those climbing the towers. Conservation agents and law enforcement officers do

spot checks of these areas. However, staff cannot be at these areas all the time, so we rely on neighbors and the general public calling our agents or the County Sheriff's office to report unlawful visitors and unsafe use.

The planning team would like to thank everyone who called or wrote in concerning these conservation areas. We appreciate your comments and concerns.

Appendix 1. Montauk Towersite Background

Visitors may climb the tower for viewing, at their own risk, but the building at the top is not open to the public.

Legal Description: Township 34 North, Range 08 West, Section 24.

Area Location: Towersite is 6 miles north of Montauk State Park on Highway 119. Turn west on County Road 6020 and travel approximately 1.25 miles to towersite.

Current Land and Water Types:

Land/Water Type	Acres	% of Area
Forest	40	100
Total	40	100

Appendix 2. Montauk Towersite Map

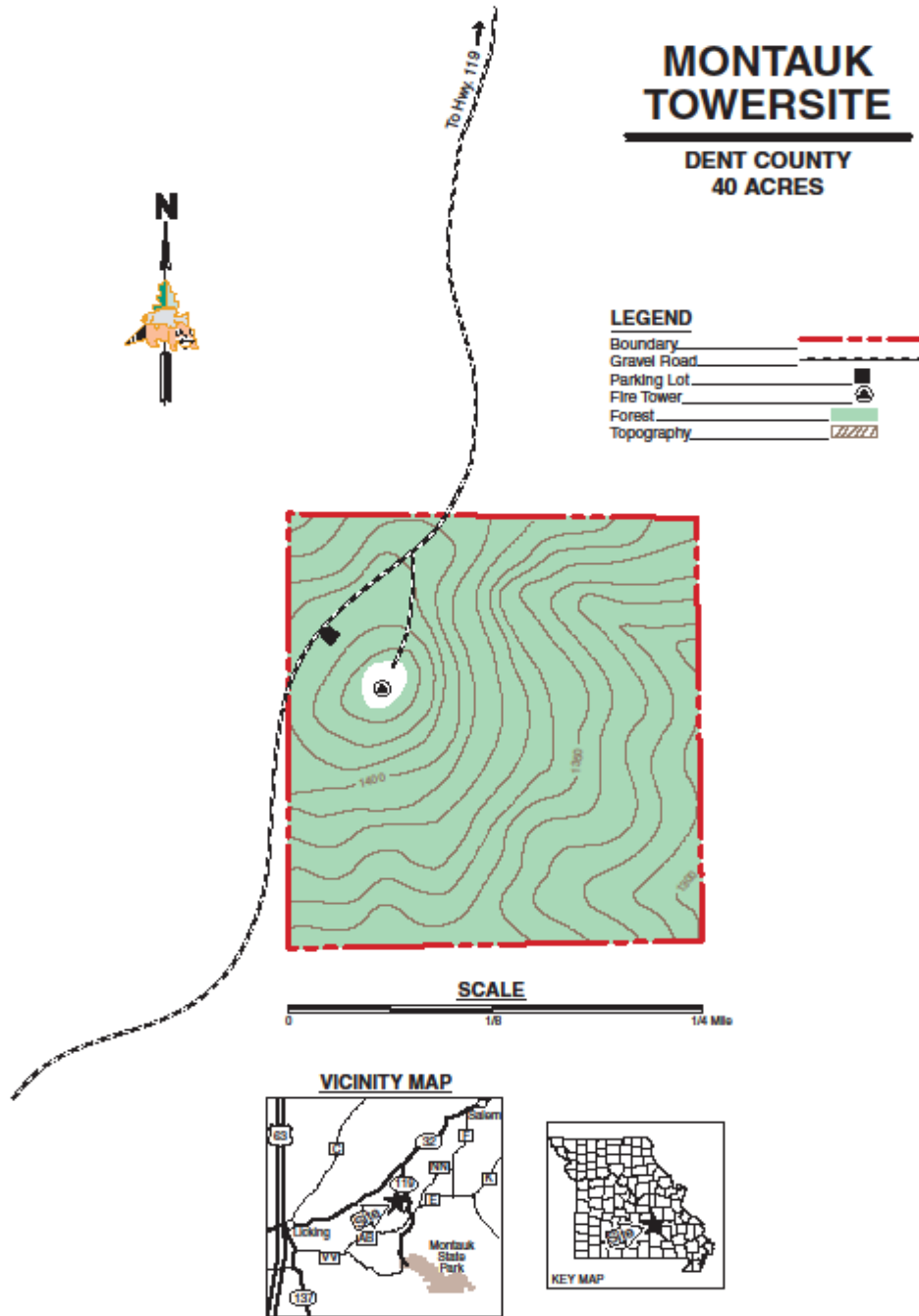

Appendix 3. Lenox Towersite Background

Visitors may climb the tower for viewing, at their own risk, but the building at the top is not open to the public.

Legal Description: Township 33 North, Range 07 West, Section 33.

Area Location: Lenox towersite is on Route C, 1 mile south of Lenox.

Current Land and Water Types:

Land/Water Type	Acres	% of Area
Forest	5	100
Total	5	100

Appendix 4. Lenox Towersite Map

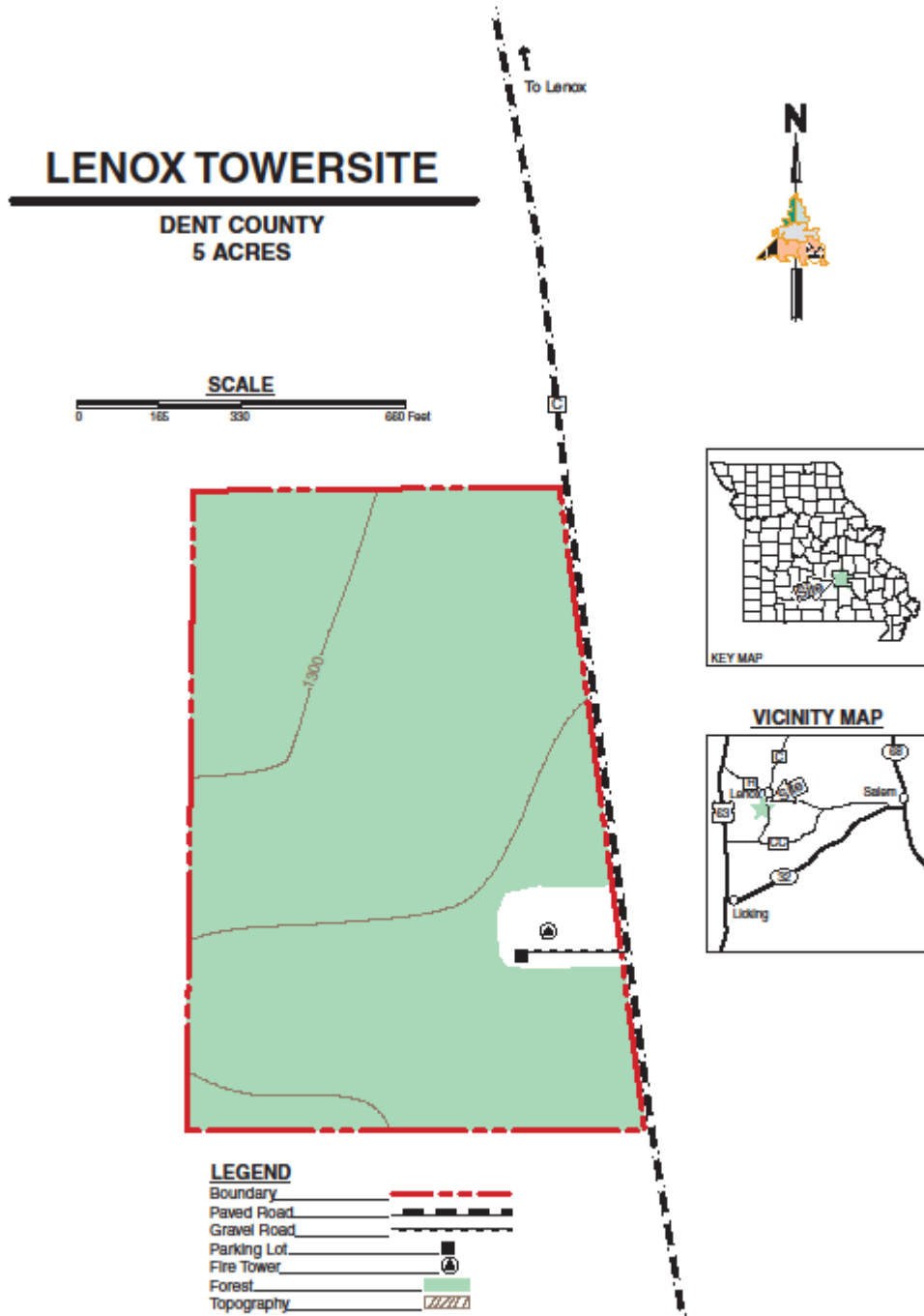

Appendix 5. Dent County Towersites Area Management Plan Public Comments

Received during public comment period (January 1-31, 2015)

The towersites provide a historic prospective and an opportunity for an outdoor adventure with family and friends. The area plan for these units seems appropriate.

If there is interest in selling the 40 acres at Montauk fire tower I would be willing to purchase the land and give rights of use for the tower and parking area to the conservation department. Please advise. In addition I would be interested in setting up a quail and Rabbit habitat to increase the population on one of my properties.

Personally we live directly behind this property and we join it, we would like to buy the acreage as this has been a party place for teens and whoever and several people climb this tower, one day someone will get hurt. I would be interested in buying this. I would fence it off and preserve the tower or you could take it. Thanks